

42 Hedley Lane, Elora - Unit 29

SQ.FT. 1,604

Bedrooms:
3

Bathrooms:
2 Full + 2 Half



Interior Unit + Finished Basement + Patio

\$799,990

SOUTH  RIVER



Your Designer Home Awaits

MOVE-IN READY

Expertly designed and curated by our Interior Design Team at Granite Homes, this home comes with the benefits of quick occupancy, a functional floor plan and premium features and finishes.



Features

MAIN FLOOR

- Designer Package A
- 9' ceilings
- Pot lights
- Garden doors off the great room
- Upgraded kitchen island cabinetry with breakfast bar
- Stainless steel fridge, stove, and dishwasher
- Luxury Vinyl Plank (LVP) flooring throughout
- Quartz countertops throughout
- Upgraded lighting features throughout main floor

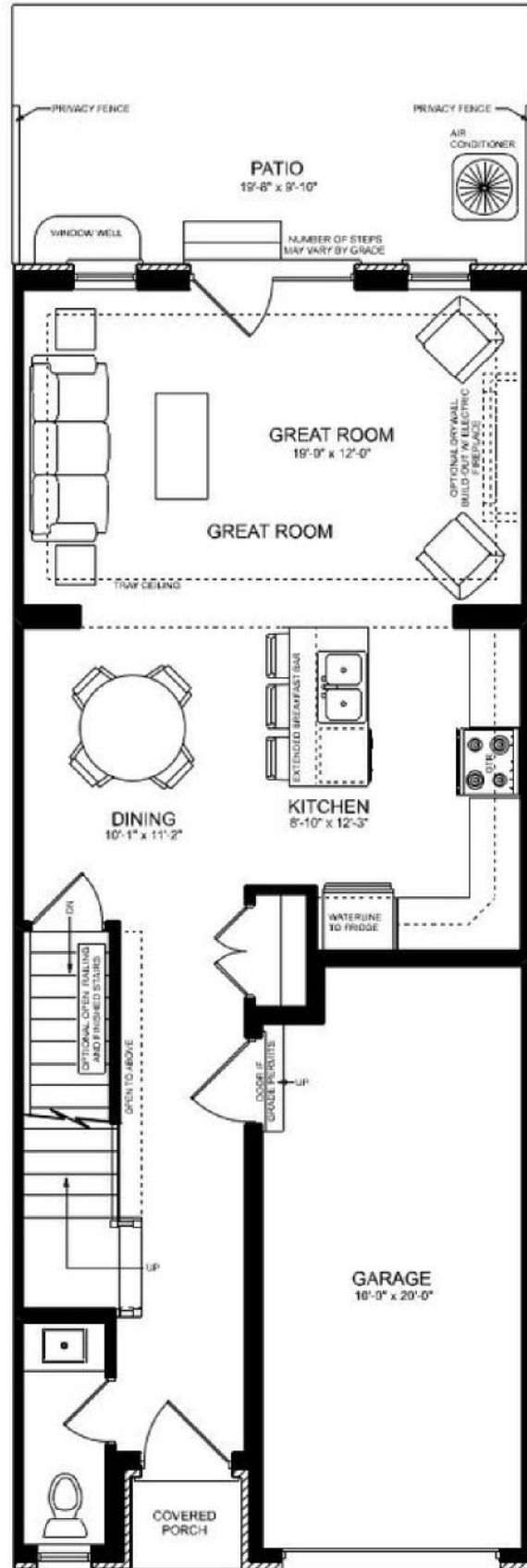

Features

SECOND FLOOR

- Laundry room with washer and dryer
- Quartz countertops in bathrooms
- Railing with iron pickets
- Pot lights in hallway

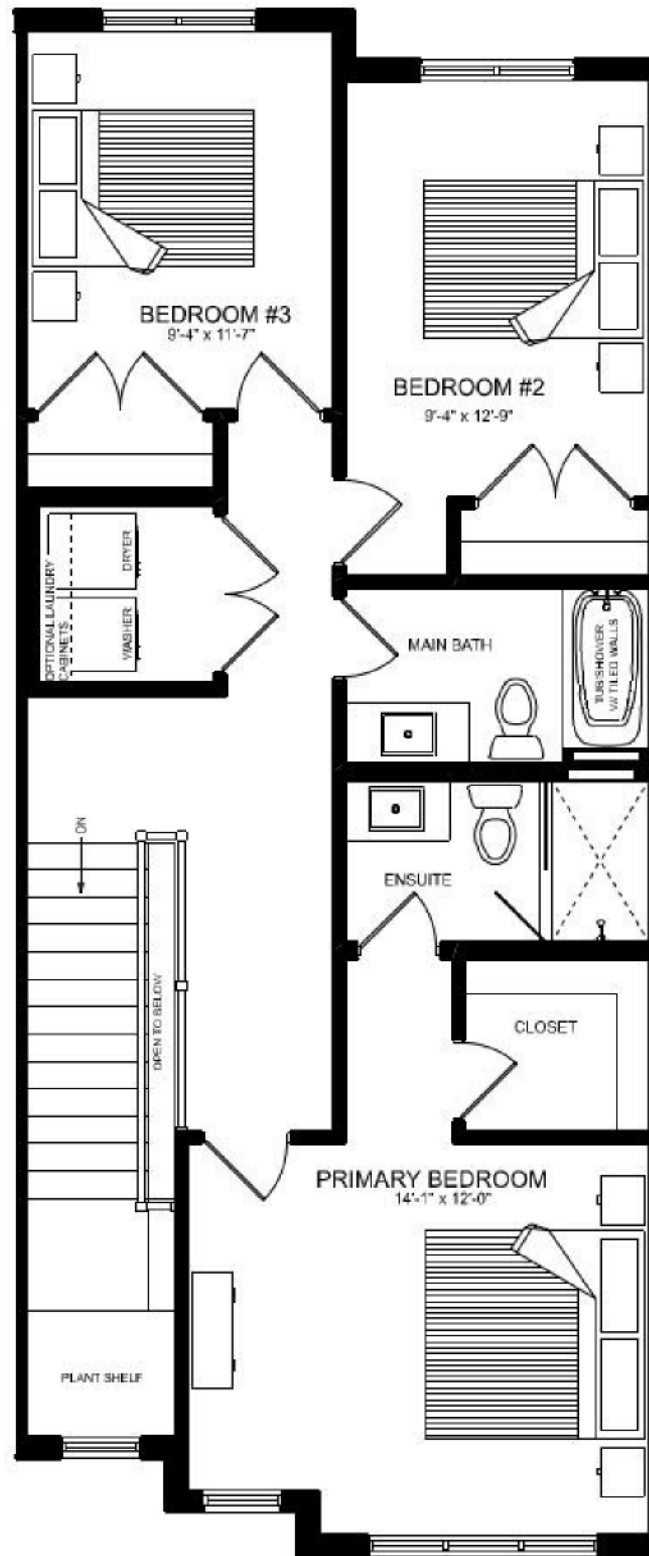

Features

BASEMENT

- Finished basement
- 2 piece bathroom
- Basement stairs opened up with railing

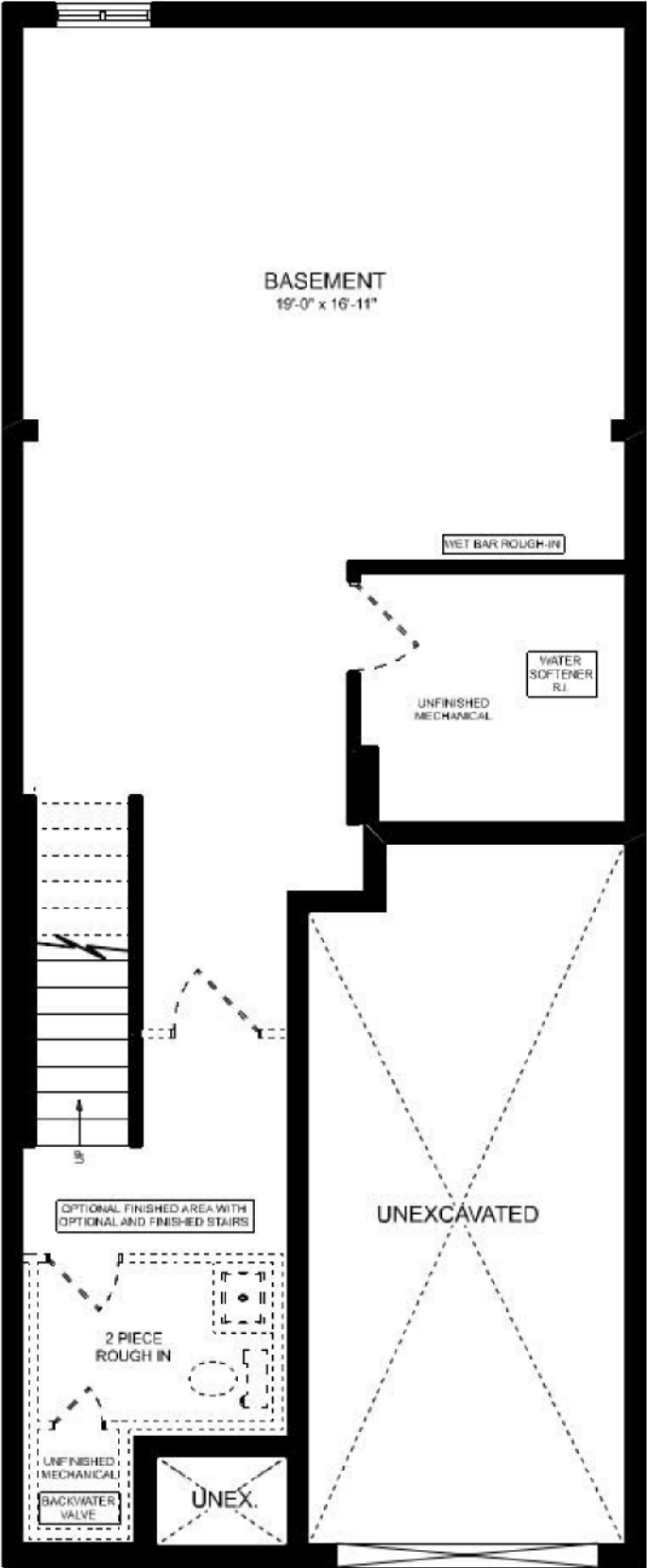

Fieldstone Site Plan



Designer Homes provide the benefits of a new home, without the wait.

DEPOSIT:
10% due on firming.

CLOSING:
As early as 30 days.

CONDO FEE:
Estimated \$235

*Included in Condo Fees:

- Exterior maintenance of homes included to ensure long-term aesthetically pleasing streetscape
- Common areas maintained by professional landscaping company
- Snow removal and maintenance of private laneway, visitor parking spaces and sidewalk
- Professional property management and administration
- Exterior lighting operated and maintained by Condominium Corporation

SANDRA AVEIRO | New Home Sales Representative
sales@granitehomes.ca | 519.222.3988

Base house prices include all sales taxes (HST). Rebate signed back to builder on closing. Prices and promotions are subject to change without notice. Please see Sales Professional for details. E. & O. E. Prices effective November 2023.

